

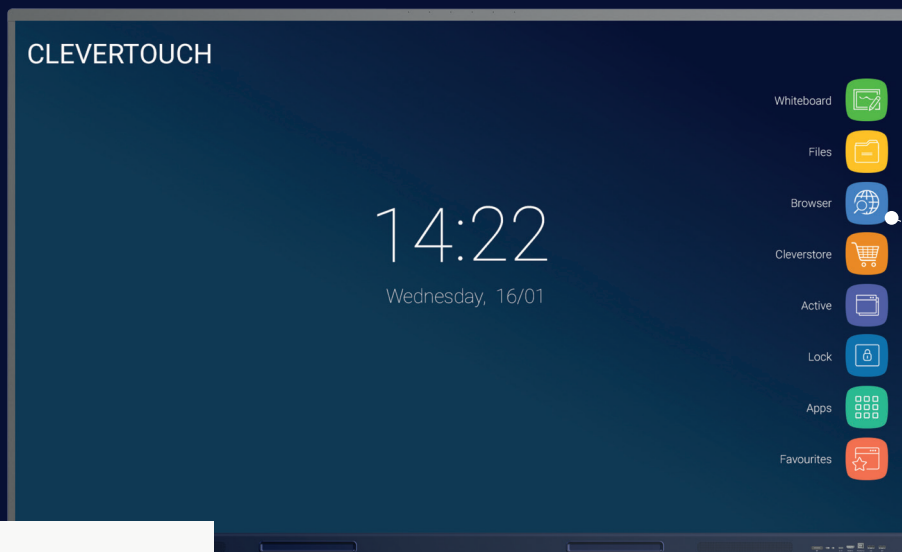

IMPACT Max

Maximum security. Maximum potential. Maximum results.

Delivering a truly intuitive and collaborative experience, IMPACT Max is an interactive screen with unlimited possibilities. Combines high-quality design, functionality, durability, native screen sharing and 4K resolution.



Quick Launch Menu for instant teaching tools
Your most commonly used apps are available with one touch and are easily accessible via the Quick Launch Menu.

Available in a range of sizes
65" | 75" | 86"

Software included at no extra cost

CLEVER® LIVE  **CLEVERSHARE®**  **CLEVERMDM®**

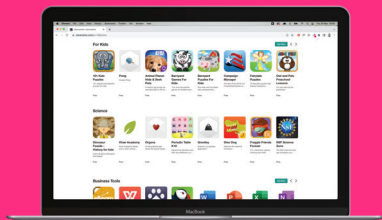

 **CLEVERSTORE®**

Choose from hundreds of apps at no extra cost. Cleverstore has apps in multiple languages and for all age groups and subjects. No adverts, no in-app purchases, no hassle.

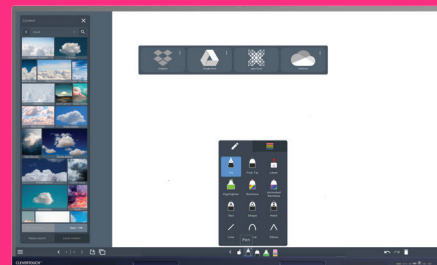

 **LYNX**
whiteboard

LYNX Whiteboard is a free-to-use lesson building app, enabling student collaboration. The most dynamic, intuitive user experience of any whiteboard

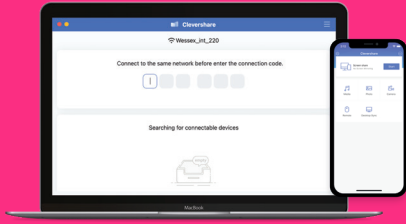

Any device can download the Clevershare app and connect instantly by typing in the code on the Clevertouch screen. Clevershare App is free to download and compatible with Android, Windows, iOS, and Chrome devices.

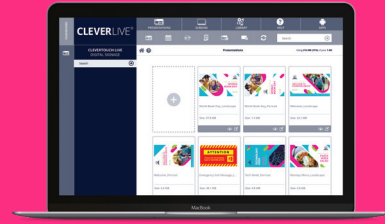

CleverLive controls all of your Clevertouch products from one central place. It is the software platform that enables the creation, deployment and management of content deployed across one or multiple displays. CleverLive is a cloud management platform and is compatible with any device.

Key Features



Designed for blended learning



LYNX Whiteboard lesson creation app



Cleverstore free app store



Clevershare screen mirroring



Remote management MDM



Customise your home screen



Full digital signage capabilities



Compatible with Google Classroom and Microsoft 365



Connect your Cloud accounts to work from anywhere



Built-in array microphone - all lessons can be recorded with sound



Latest generation USB-C with charging and hardware optimization



2 x 20W speakers for room-filling sound



IMPACT Max is an Award-Winning Clevertouch Interactive Display.

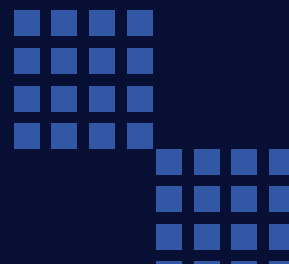

IMPACT Max Specifications

Display

| | |
|-------------------------------|--|
| Diagonal Size | 65" 4K, 75" 4K, 86" 4K |
| Screen Type | TFT LCD - Direct LED Backlight |
| Aspect Ratio | 16:9 |
| Display Colours | 1.07 Billion (10 bit) |
| Resolution | 4K UHD (3840x2160 @60Hz) |
| Response Time | 5ms |
| Refresh Rate | 60Hz |
| LCD Viewing Angle | 178° |
| Brightness | 450 cd/m2 |
| Contrast Ratio | 65" 4000:1 75" 5000:1 86" 4000:1 |
| Dynamic Contrast Ratio | 65" 6000:1 75" 6000:1 86" 6000:1 |
| Glass Hardness | Tempered Glass - Mohs Level 7 |
| Glass Thickness | 3mm |
| Glass Type | Low Parallax 1mm Air Gap - Heat tempered |
| Main Board | Amlogic T982 (SoC) |
| Life of Screen | 50,000 Hours |
| NTSC | 65" 72% 75" 72% 86" 68% |

Interactivity

| | |
|--|---|
| Writing Technology | High Precision IR Technology |
| Continuous Touch Points | 20 |
| Touch Resolution | 32768x32768px |
| Response Time | ≤5ms |
| Touch Accuracy | 1mm |
| Minimum Object Size | 3mm |
| Touch Tool | Finger, passive pen, opaque objects |
| Simultaneous Writing | Yes |
| Ink In Tools | Yes - Lynx |
| Pens Included | 2 |
| Pen Type | Dual Recognition Stylus Super Cool Stylus |
| Pen Holder | Integrated magnetic pen holders |
| Pen Tip Diameter | 3mm/7mm |
| Pen & Touch Differentiation | Yes |
| Pen Identities | 2 |
| Palm Rejection | Yes |
| Annotation Over Any Source | Yes |
| Classroom Essential Apps | Includes Whiteboard, Annotate, Timer, Media Players, Browser, PDF Reader, Screen Record, Spinner, Voting, Maths Tools |
| Compatibility* | Windows 10, Linux, Mac, Android, Chrome |
| Tracking Rate | ≥1m/s |
| Scan Rate | 200Hz |
| Gestures & Edge Swipes | Windows Supported, OSX With additional Driver |

Connectivity

| | |
|---|--|
| OPS Slot | 1 - Intel Spec 80Pin |
| HDMI In | 3 |
| HDMI Out | 1 |
| USB-A 2.0 | 1 |
| USB Touch (type B) | 2 |
| USB A 3.0 (Faster Data Transfer) | 4 |
| USB C (Video, Audio & Touch) | 1 (supports 65W charging) |
| LAN In (RJ45) | 1 GB |
| LAN Out (RJ45) | 1 |
| RS-232 | 1 |
| Wake-on-Lan | Yes |
| Wireless Adapter 2.0 + WAP | Yes |
| Clevertouch WiFi Module | Yes |
| Bluetooth | Yes 5.0 |
| Displayport In | No |
| VGA In | 1 |
| Audio In | 1 |
| Optical Out | 1 |
| Headphone | 1 (3.5mm) |
| Total touch out ports | 2 |
| NFC Reader / Writer | Optional Extra |
| Camera | Optional Extra |
| Proximity Sensor | No |
| Array Mic | 6 |
| WiFi | IEEE 802.11a/b/g/n/ac/ax with 2 × 2 MIMO (hotspot only) (both 2.4 and 5 GHz bands) |
| WiFi Speed | Capable of speeds up to 433Mbps |

Computing

| | |
|----------------------------|---------------|
| Operating System | Android 11 |
| System Version | LUX 11 |
| RAM | 8GB |
| Internal Storage | 64GB |
| CPU | Quad Core A55 |
| GPU | Mali G52MP2 |
| Android Resolution | 4K |
| Android Module Slot | No |
| System Architecture | 32-bit |
| Integrated LUX UI | Yes |

Power

| | |
|------------------------------------|---|
| Power Requirements | 100-240V ~ 50/60Hz |
| Power Consumption (Standby) | ≤0.5W |
| Ultra Quiet Fanless Design | Yes |
| Power Consumption | 65" 178 Watts 75" 183 Watts 86" 195 Watts |

IMPACT Max Specifications

Audio

| | |
|---|---------|
| Dual Front Facing, Bass Enhanced Speakers | 2 x 20W |
| Audio Out | Yes |
| SPDIF / Fibre | Yes |
| Sound Channel | 2 |
| Line Array Microphone | Yes |
| Super Wide Sound | No |

Operating & Storage Environment

| | |
|-----------------------|-------------------|
| Operating Temperature | 0° to 40° |
| Storage Temperature | -20° to 60° |
| Operating Humidity | 10% to 90% RH |
| Storage Humidity | 10% to 90% RH |
| Altitude | Below 5000 metres |

Physical Spec

| | |
|-------------------|---|
| Panel Dimensions | 65" 1489x906x87mm 75" 1709x1013x88mm 86" 1957x1168x88mm |
| Packed Dimensions | 65" 1628x208x1005mm 75" 1863x225x1148mm 86" 2110x225x1291mm |
| Net Weight | 65" 35.9kg 75" 47.75kg 86" 62.9kg |
| Packed Weight | 65" 46.25kg 75" 61.9kg 86" 80.6kg |
| VESA Mount Point | 65" 600x400mm 75" 800x400mm 86" 800x600mm |

Inside your Clevertouch Box

| | |
|-------------------|--|
| What's In The Box | (1) Clevertouch IMPACT MAX (1) 1.5M Length HDMI Cable (1) 3M Length USB cable (A-B) (1) 1.5M USBC Cable (1) 3M Regional Power Cable (1) Remote Control (2) Batteries for Remote Control (2) Dual Recognition Stylus (1) User Guide (1) Quick Install Guide (1) Clevertouch WiFi Module |
|-------------------|--|

IMPACT Max Built-In Features

| | |
|--|--|
| LYNX™ App With Online Lesson Planning | Yes |
| Cleverstore™ App Store For Education | Yes |
| Embedded Digital Signage | Yes |
| Clevershare™ Mirroring Any Device To The Board | Free for the life of the screen (touch back) |
| Integrated Personalised Accounts Profiles | Yes |
| Cloud Account Access | OneDrive, Google Drive, LYNX Cloud |
| Embedded Room Booking | Yes |
| Whiteboard Annotation | Yes |
| Email Out Direct From Touchscreen | Yes |
| Scan QR Code For Saving Work | Yes |
| Alerts and Announcements | Yes |
| Over-the-Air Updates | Yes |
| Remote Management Of Touchscreens (MDM) | Yes - Five year license |
| CleverLauncher™ | Yes |
| LynxShare™ | Yes |
| LynxCloud™ | Yes |

Warranty

Warranty term and upgrade options vary by region. Contact your local reseller or distributor for information and visit clevertouch.com/about/warranty

Compliance & Certification

| | |
|--------------------------|--------------------------------|
| Regulatory Certification | CE, FCC, UL, Energy Star & EEC |
|--------------------------|--------------------------------|



Support

For all Clevertouch products, visit: support.clevertouch.com

Statement

Size and weight vary by configuration and manufacturing process, please refer to the actual product. The product images are for illustrative purposes only and may slightly differ in appearance, colour, size, etc. from the actual product. The description, illustrations, etc. in this document may subject to change in accordance with the latest product specification and performance. Should the above-mentioned change in the document become necessary, the document may be updated without written notice.